

- Note:
1. All dimensions noted are in millimetres unless stated otherwise.
  2. Do not scale from this drawing, if dimensions are not clear ask.
  3. This document has been created in accordance with Plandescil Ltd Terms & Conditions along with the scope of works provided by the client to Plandescil. Any use of this document other than for its original purpose is prohibited. Plandescil accept no liability for any third party sites of this document.
  4. Plandescil Ltd to be immediately notified of any suspected omissions or discrepancies.
  5. This drawing is to be read in conjunction with all other relevant documents relating to the project.
  6. See Plandescil Ltd Drawing No. 20217\_150 for Red Line Boundary Details.

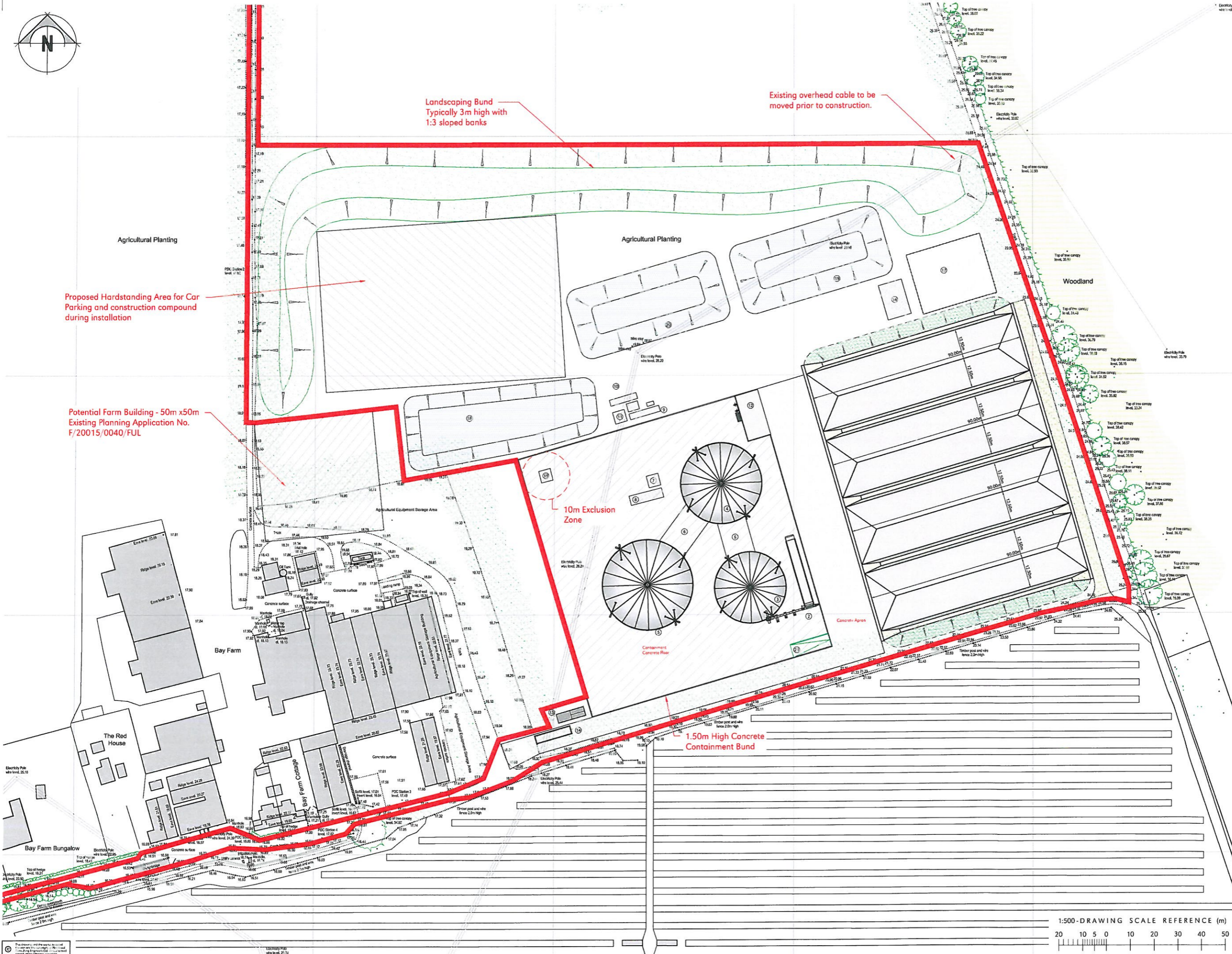

Landscaping Bund  
Typically 3m high with  
1:3 sloped banks

Existing overhead cable to be  
moved prior to construction.

Proposed Hardstanding Area for Car  
Parking and construction compound  
during installation

Potential Farm Building - 50m x50m  
Existing Planning Application No.  
F/20015/0040/FUL

10m Exclusion  
Zone

1.50m High Concrete  
Containment Bund

- PLANT KEY
- 1 Silage Clamps (4No 90m x 25m)
  - 2 Feed Hopper
  - 3 Digester (130m<sup>3</sup>)
  - 4 Digester (34m<sup>3</sup>)
  - 5 First Digester (38m<sup>3</sup>)
  - 6 Technical Building
  - 7 Compressor
  - 8 Gas Cooling Grid
  - 9 CHP Base
  - 10 Transformer
  - 11 Oil Tank Base
  - 12 Digestate Storage Area
  - 13 Weighbridge Cabin (12m x 4m)
  - 14 Weighbridge
  - 15 Emergency Flare Base
  - 16 Propane Tank Base
  - 17 Gas Upgrading Compound
  - 18 Surface Water Infiltration Pond
  - 19 Digestate Storage Lagoon
  - 20 Lined Testing Lagoon
  - 21 Access Ramp

- FINISHED SURFACES KEY
- Asphalt Surface
  - Concrete Surface
  - D.O.T Type 1 Surface
  - Redline boundary

**FOR PLANNING**

Rev	Date	Chd	Description
G	07-10-15	DAJ	Redline Boundary Amended
F	11-09-15	DAJ	Issued for Planning Consultants
E	08-09-15	DAJ	Issued for Planning Consultants
D	08-09-15	DAJ	Amendments Following Comments
C	04-09-15	DAJ	Amendments Following Comments
B	03-09-15	DAJ	Amendments Following Comments
A	01-09-15	DAJ	Amendments Following Comments
0	07-08-15	DAJ	First Issue

**plandescil**  
consulting engineers

Connaught Road, Ashborough, Northants, NN17 2BW  
Telephone: 01953 435001 Fax: 01953 435055  
Email: john.plandescil@plandescil.co.uk www.plandescil.co.uk

civil • structural • environmental • surveying

Client  
**Strutt & Parker Farms Ltd.**

Project  
**Proposed AD Plant,  
Bay Farm, Red Lodge,  
IP28 6BS**

Drawing Title  
**Proposed Site Layout**

1:500-DRAWING SCALE REFERENCE (m)

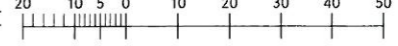

Scale	U.N.O.	Date	Drawn by
1:500 (A0)		August 2015	AF
Drawing No.		20217/004	Rev
			G